

How To Install your Drain System

KIT OPTIONS

- 10 FEET 102 TO 304 (3 SECTIONS)
- 20 FEET 102 TO 607 (6 SECTIONS)
- 30 FEET 102 TO 9010 (9 SECTIONS)
- 40 FEET 102 TO 12013 (12 SECTIONS)

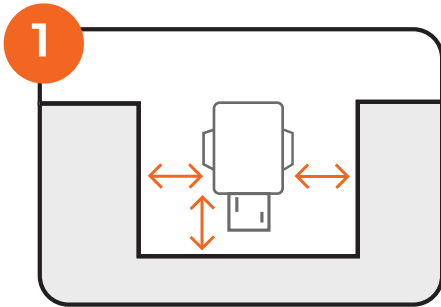
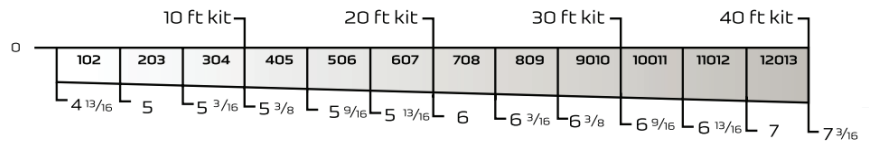

Prepare the Area:

Dig a trench that's wide enough for the channel and an additional 2-3 inches of space, for concrete or other encasement material on all sides.

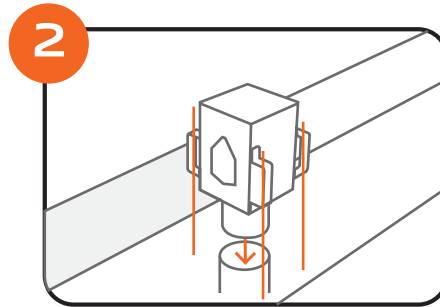

Install Catch Basin:

Attach the catch basin to underground piping via the catch basin outlet. Use a continuous bead of silicone sealant at all connection points. Level as required using rebar.

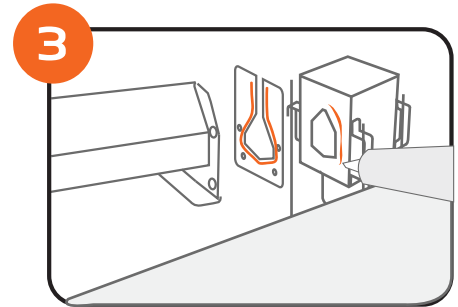

Install First Section:

Place highest numbered channel section in trench. Attach the section to the catch basin, using the catch basin adapter, a continuous bead of silicone sealant and hardware (Part D,E,F).

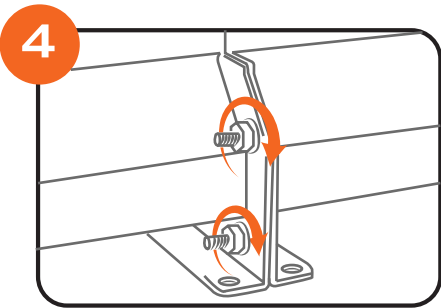

Join Remaining Channels:

Connect numbered channels sequentially using section hardware (Part A,B,C) and a continuous bead of silicone sealant. Refer to the modular layout and labels on each part to ensure correct slope direction.

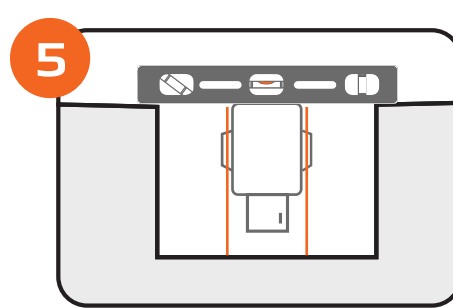

Level the System:

Slide rebar rods into the mounting brackets on each channel to hold it steady and level. Ensure the complete slot drain system is level and held securely in place while pouring concrete.

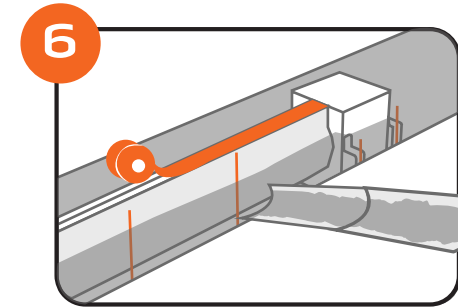

Pour the concrete:

Apply tape over the opening to protect the system from concrete. Pour concrete around the system to be flush with the desired floor finish level. Ensure a consistent fill around the drain free of voids that could compromise drain stability.

7

Clean up and Enjoy! Let the concrete cure completely to manufacturer's specification. Once it's set, peel off the tape and remove orange spacer tabs if supplied. You now have a neat, professional-looking finish.



Online Instructions